

CUSTOMER COPY

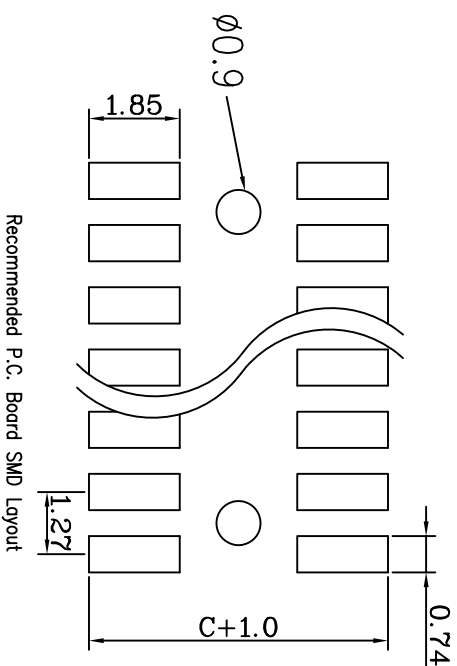
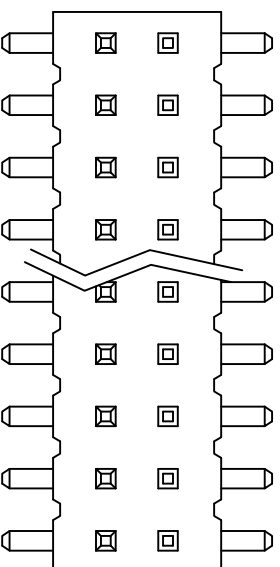

Recommended P.C. Board SMD Layout

ORDER INFORMATION

171 40 10 XX X

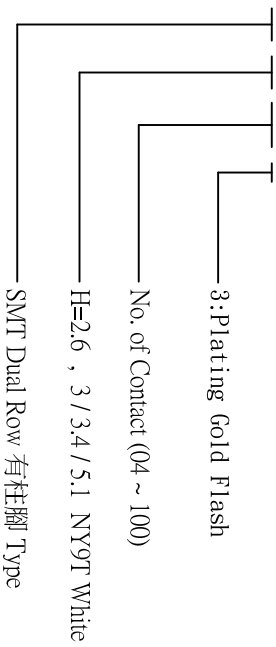

SPECIFICATION

MATERIAL

- * Current Rating: 1 A
- * Withstanding Voltage: 600 VAC (1 min.)
- * Insulation Resistance: 1000 Megohms MIN.
- * Contact Resistance: 30 Milliohms MAX.
- * Operating Temperature: -55°C to +105°C
- * Retention Force: 450g MIN.
- * Contact: Copper Alloy
- * Insulator: Nylon 6T
- * Terminal: Phosphor Bronze/Brass
- * Plating: Selective Gold

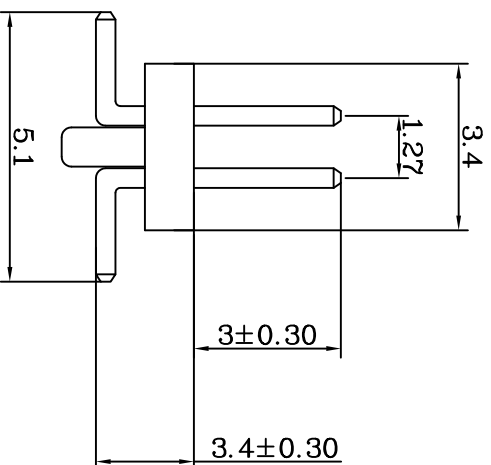
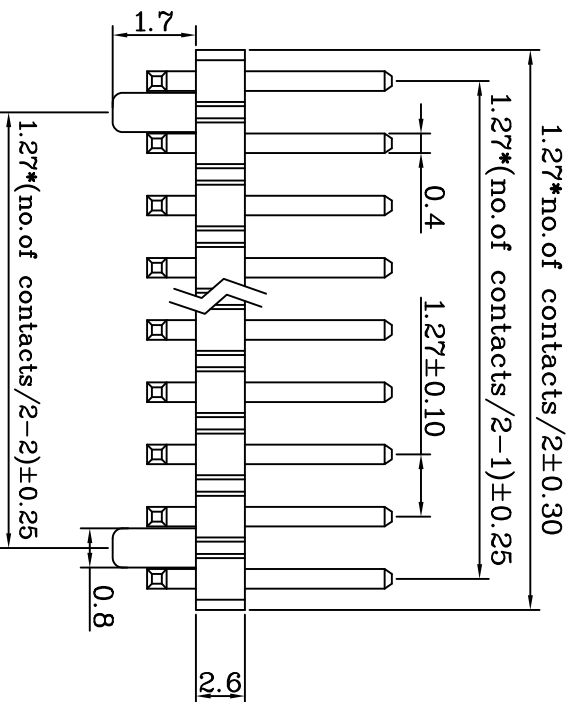

钰满荣企业股份有限公司 ACMELUX CO., LTD.

TEL: 886-2-85124595

FAX: 886-2-85124322

0.0±0.30	SCALE: 1:1	TITLE:	PART NO:
0.00±0.20	UNIT: mm	Pitch 127mm Dual Rows SMD Type Pin Header Connector	107700
0.000±0.1		MATL: RoHS (Nylon 9T)	CHK BY: Cheryl
		DWG. NO. C1714010XXXX	DR BY: Amos

REV.	DESCRIPTION	APP.	DATE
A	NEW DESIGN	Amos	2013-04-02