

CUSTOMER COPY

REV.	DESCRIPTION	APP.	DATE
A	NEW DESIGN	Amos	2009-11-19

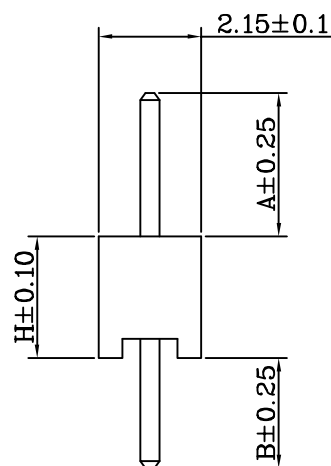
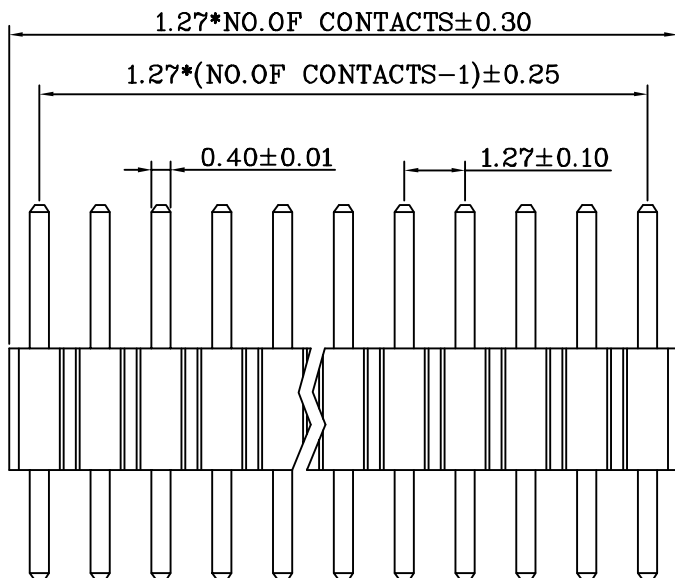

ORDER INFORMATION

171 08 XX XX X

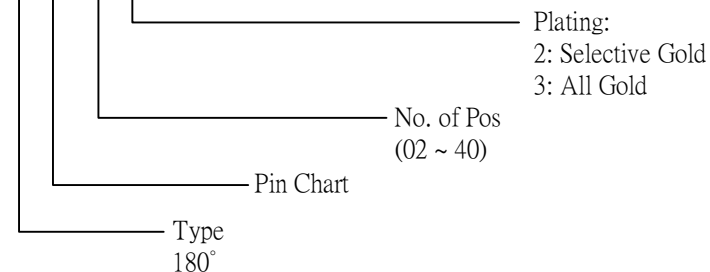

SPECIFICATION

- * Current Rating: 1 A
- * Withstanding Voltage: 600 VAC (1 min.)
Insulation Resistance: * 5000 Milliohms MAX.
- * Contact Resistance: 30 Milliohms MAX.
- * Operating Temperature: -55°C to +105°C
- * Retention Force: 450g MIN.

MATERIAL

- * Contact: Copper Alloy 0.40mm square post.
- * Insulator: High Temperature plastic.
- * Plating: Selective Gold or ALL Gold

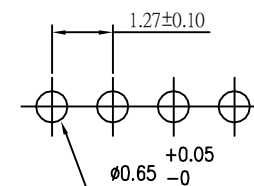

Recommended P.C. Board Hole Layout

Pin Chart

No.	A	B	H	No.	A	B	H	No.	A	B	H	No.	A	B	H
00	7.60	1.80	1.00	11	3.50	1.35	1.00	22	8.50	8.50	1.00	33	5.00	2.00	1.00
01	3.50	1.80	1.00	12	6.00	2.00	1.00	23	4.50	2.10	1.00	34	3.50	2.20	2.50
02	3.00	2.30	1.50	13	4.50	1.50	2.00	24	1.80	1.80	1.00	35	2.70	2.50	2.50
03	3.00	2.30	1.00	14	4.50	2.00	2.00	25	4.00	2.00	2.00	36	2.00	1.80	2.00
04	5.20	1.70	1.00	15	2.00	2.00	1.70	26	7.00	1.80	1.00	37	2.00	1.80	5.00
05	3.00	2.30	2.00	16	2.00	2.00	2.00	27	2.80	2.60	3.40	38	3.00	1.00	1.70
06	2.00	2.00	3.00	17	2.80	2.50	1.00	28	4.00	2.40	1.00	39	1.50	1.50	2.00
07	3.20	2.10	1.00	18	5.50	2.00	2.00	29	2.50	2.80	1.70	40	3.00	2.10	2.00
08	4.00	2.10	1.00	19	1.80	2.00	1.00	30	7.60	1.80	1.70	41	6.00	3.00	2.50
09	1.50	1.50	1.00	20	2.50	2.80	1.50	31	4.00	2.10	1.70	42			
10	2.00	2.00	1.00	21	3.00	2.30	1.70	32	6.00	3.00	1.00	43			



鈺滿榮企業股份有限公司 ACMELUX CO., LTD.

TEL:886-2-85124595

FAX:886-2-85124322

0.0±0.30	SCALE: 1:1	TITLE:	PART NO:
0.00±0.20	UNIT: mm	Pitch 1.27mm(.05") DIP Single Row Type Pin Header Connector	APP BY: Hung
0.000±0.1		MATL: RoHS (Nylon)	CHK BY: Cheryl
DWG. NO. C17108XXXXXX		DR BY: Amos	