

CUSTOMER COPY

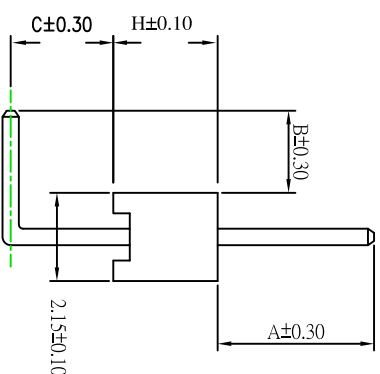
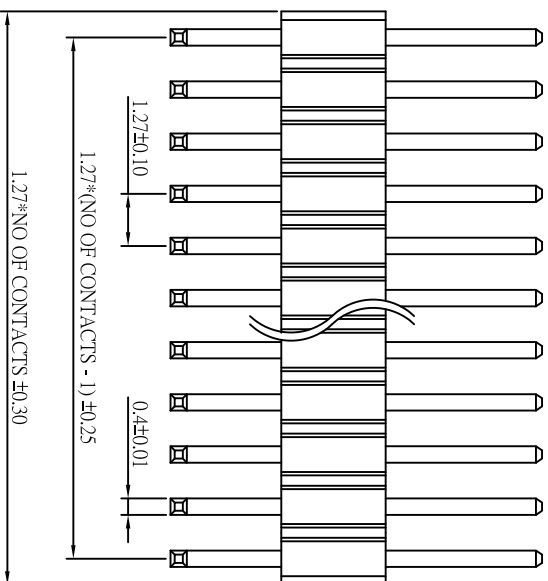

Pin Chart

No.	A	B	C	H
00	4.50	4.50	0.75	1.00
01	2.00	2.50	4.00	1.00
02	3.00	2.60	1.25	1.50
03	3.00	2.50	1.75	1.00
04	2.80	2.00	1.00	1.50
05	3.00	2.30	0.75	1.50
06	3.00	3.00	1.25	1.50
07	2.00	2.50	0.75	0.8

Pin Chart

No.	A	B	C	H
08	3.00	4.10	2.90	1.50
09	3.00	4.10	2.70	1.50

ORDER INFORMATION

171 04 XX XX X

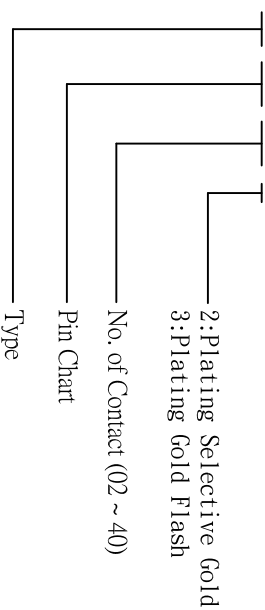

SPECIFICATION

- \* Current Rating: 1 A
- \* Withstanding Voltage: 600 VAC ( 1 min. )
- Insulation Resistance: \* 1000 Millions MAX.
- \* Contact Resistance: 30 Milliohms MAX.
- \* Operating Temperature: -55°C to +105°C
- \* Retention Force: 450g MIN.

MATERIAL

- \* Contact: Phosphor Bronze 0.40mm square post.
- \* Insulator: High temperature plastic
- \* Plating: Selective Gold or ALL Gold

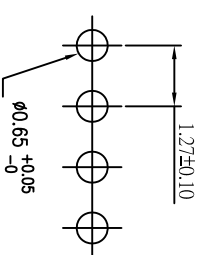

Recommended P.C. Board Hole Layout

REV.	DESCRIPTION	APP.	DATE
A	NEW DESIGN	Amos	2009-05-05



钰满荣企业股份有限公司 ACMELEX CO., LTD.

TEL:886-2-85124595

FAX:886-2-85124322

0.0±0.30	SCALE: 1:1	TITLE: Pitch 1.27mm (05") Center	PART NO: 107120
0.00±0.20	UNIT: mm	0.40mm R/A Single Row	APP BY: Hung
0.000±0.1		Type Pin Header Connector	CHK BY: Cheryl
		MATL: RoHS (Nylon 6T)	DR BY: Amos
		DWG. NO. C17104XXXXXX	

