

CUSTOMER COPY

ORDER INFORMATION

1242 2 X X XX X

REV.	DESCRIPTION	APP.	DATE
A	NEW DESIGN		

No. Of Contact
(02 ~ 20)
Plating:
1: Tin

Nc Pin

Style

0: Straight
1: Right angle

Type
2: VH Type (RoHS)

MATERIAL

SPECIFICATION

- * Contact: Brass ,
- * Insulator: NYLON 66
- * Plating: Tin
- * Current Rating: 7 A
- * Withstanding Voltage: 1000 VAC (1 min.)
- * Insulation Resistance: 1000 Megohms MIN.
- * Contact Resistance: 20 Milliohms MAX.
- * Operating Temperature: -40°C to +85°C
- * Retention Force: 1 Kg MIN.

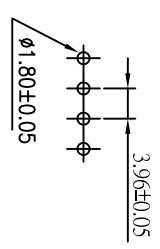

Recommended P.C. Board Hole Layout

- * Retention Force: 1 Kg MIN.

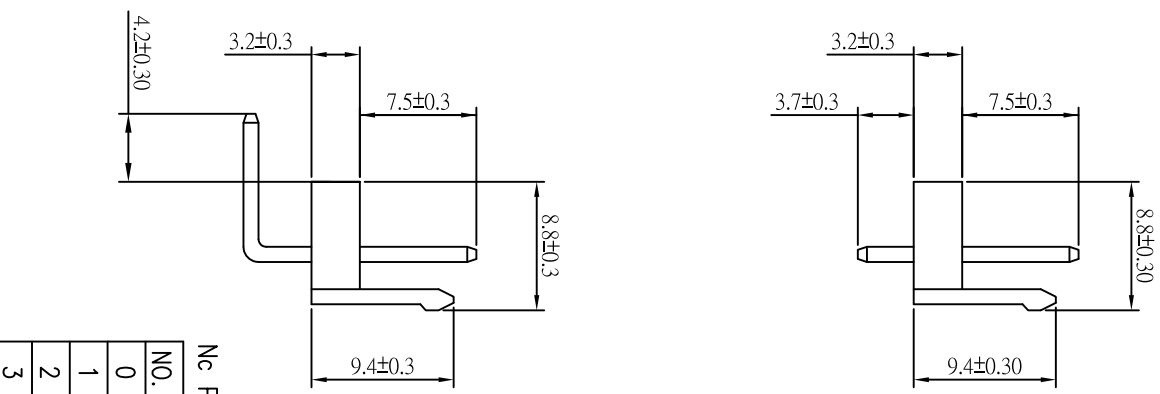
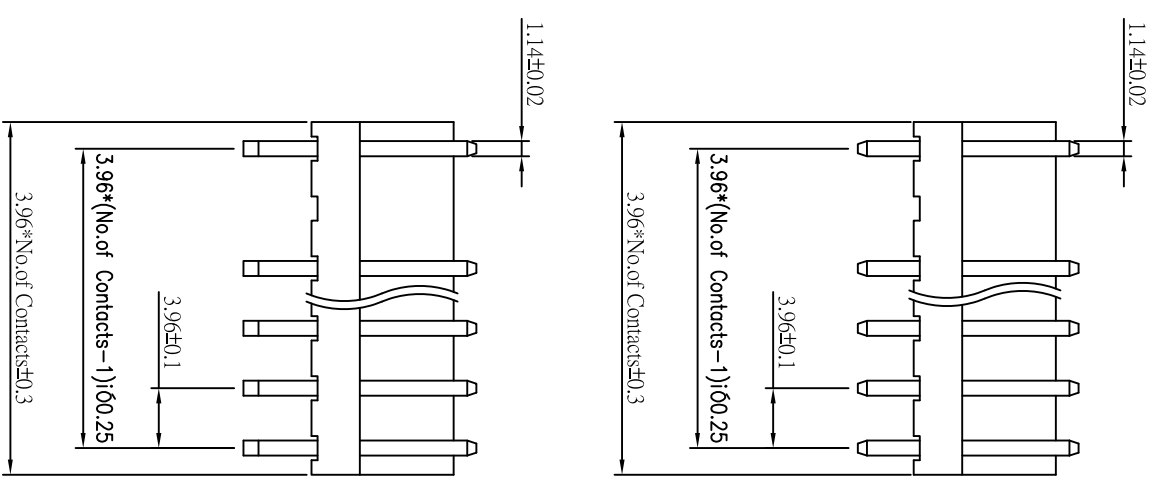

Nc Pin Chart

NO.	Nc Pin
0	2
1	5,6,9,11
2	5,6,9,12,14
3	2,4
4	



钰满荣企业股份有限公司 ACMELEX CO., LTD.

TEL.:886-2-85124595

FAX:886-2-85124322

0.0±0.30	SCALE: 1:1	TITLE:	PART NO:
0.00±0.20	UNIT: mm	Pitch 3.96mm (.156") VH Type	APP BY: Hung
0.000±0.1		Water Connector	CHK BY: Cheryl

	MATL: RoHS	DR BY: Amos
	DWG. NO. C12422XXXXXX	