

CUSTOMER COPY

REV.	DESCRIPTION	APP.	DATE
A	NEW DESIGN	Amos	2010-03-29

■ SPECIFICATIONS

- Voltage Rating : 125 V AC/DC
- Current Rating : 3A AC/DC
- Withstanding Voltage : 1,000V AC/minute
- Insulation Resistance : 1,000MΩ min
- Temperature Range : - 25°C to + 85°C
- Contact Resistance : 20mΩ max

■ WAFER

- Part No. : JS-6254-XX
- Poles : 2 - 12(Straight)
- Material : Contact : Brass, Tin Plated
Base : Nylon 66 UL94V-0

ORDER INFORMATION

1231 4 0 X XX 1

1:Plated Tin
No. of Contact
0:米白色
1:豬肝紅色
0:180°
Molex Type 短靠背 (RoHS)

RoHS

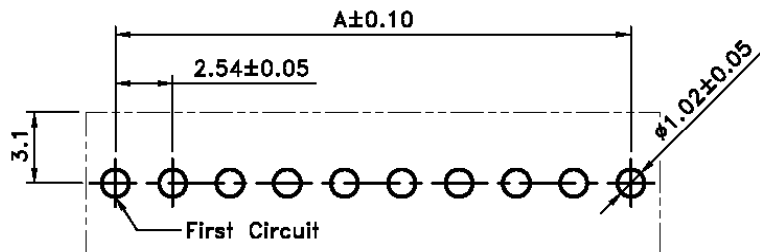

Recommended PCB Layout(Top View)

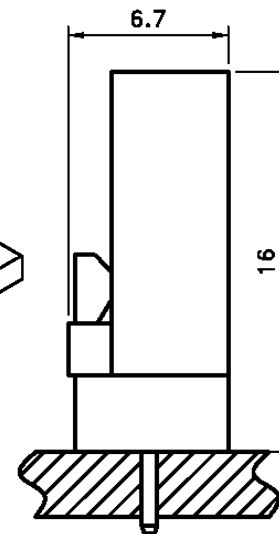
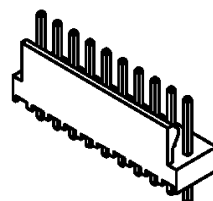
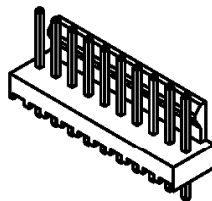
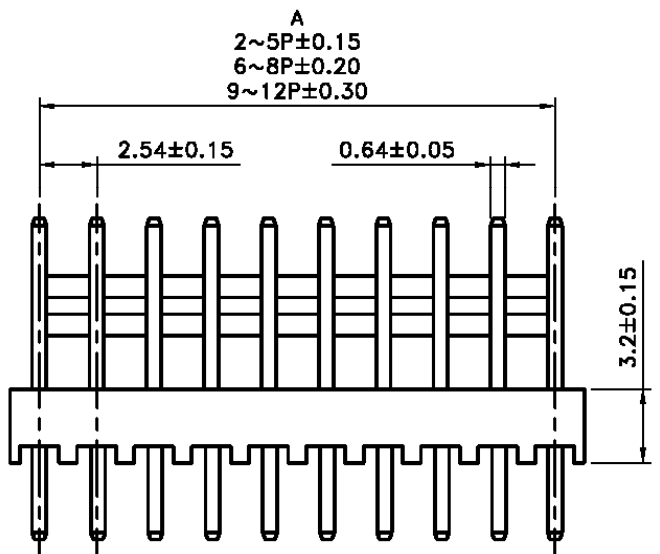
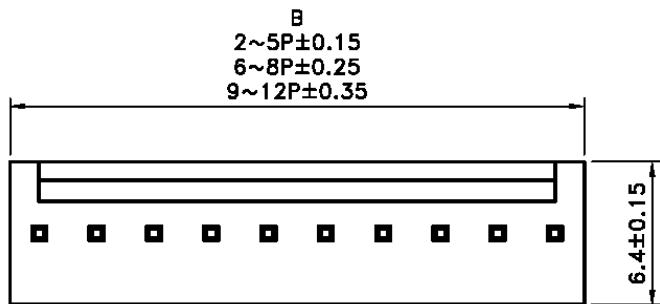

Assembly Layout (REF.)

Poles	Dimensions(mm)	
	A	B
2	2.54	5.10
3	5.08	7.68
4	7.62	10.24
5	10.16	12.78
6	12.70	15.24
7	15.24	17.88
8	17.78	20.44
9	20.32	23.00
10	22.86	25.54
11	25.40	28.10
12	27.94	30.64



鈺滿榮企業股份有限公司 ACME LUX CO., LTD.

TEL: 886-2-85124595 FAX: 886-2-85124322

0.0±0.30	SCALE: 1:1	TITLE:	PART NO:
0.00±0.20	UNIT: mm	Pitch 2.54mm 180° 短靠背 Type Wafer Connector	APP BY: <i>Hung</i>
0.000±0.1			CHK BY: <i>Cheryl</i>
		MATL: RoHS	DR BY: <i>Amos</i>
		DWG. NO. C123140XXX1	A244