

CUSTOMER COPY

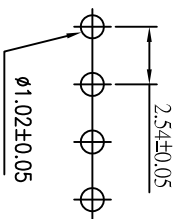
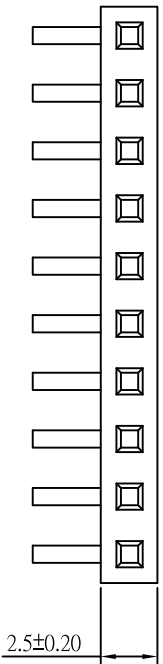

Recommended P.C. Board Hole Layout

ORDER INFORMATION

189 00 XX XX X

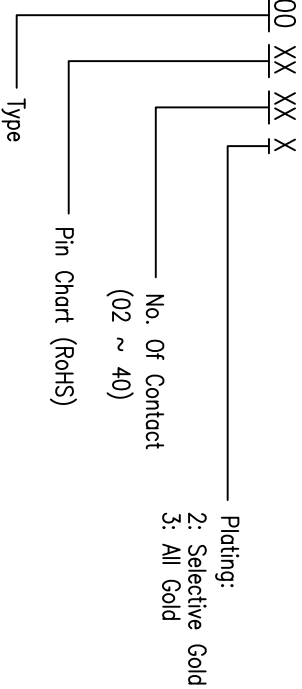

REV.	DESCRIPTION	APP.	DATE
A	NEW DESIGN		

SPECIFICATION

- * Current Rating: 3 A
- * Withstanding Voltage: 500 VAC (1 min.)
- * Insulation Resistance: 1000 Megohms MIN.
- * Contact Resistance: 30 Milliohms MAX.
- * Operating Temperature: -40°C to +85°C
- * Retention Force: 450g MIN.

MATERIAL

- * Contact: Brass
- * Insulator: High temperature plastic
- * Plated: Gold

Pin Chart

No.	A	H
60	3.30	8.50

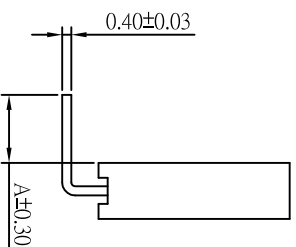
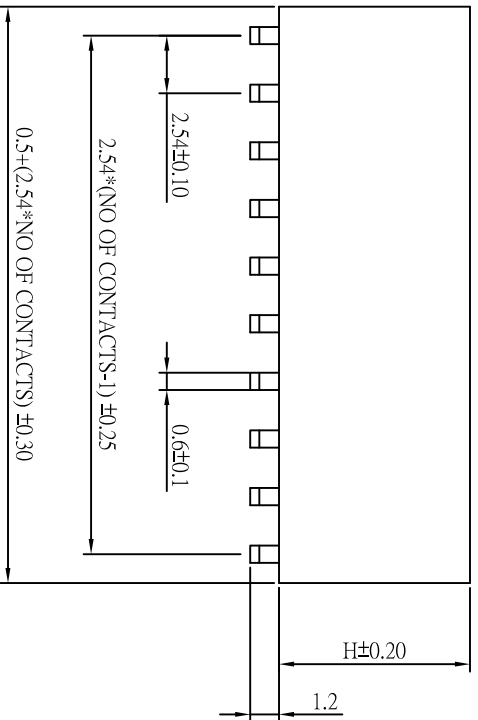

0.0±0.0000	0.30	SCALE: 1:1	TITLE: 2.54mm (.100")Center	PART NO: 117110
0.00±0.0000	0.20	UNIT: mm	Female Header	APP BY: Hung
0.0000±0.10			R/A Single Row Profile	CHK BY: Cheryl
			MATL: RoHS	DR BY: Amos



ACMELUX CO., LTD.

TEL:886-85124595

FAX:886-85124322



DWG. NO. C18900XXXXXX

DR BY: Amos