

CUSTOMER COPY

| REV. | DESCRIPTION | APP. | DATE |
|------|-------------|------|------------|
| A | NEW DESIGN | Amos | 2011-12-02 |

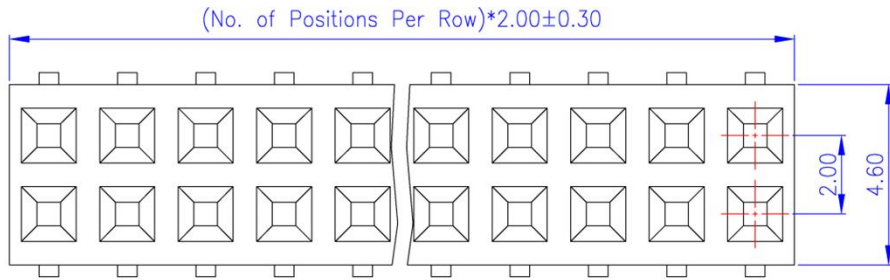

ORDER INFORMATION

188 48 00 XX X

- 3:Plating Gold Flash
- No. of Contact (02~40 Pin)
- H:4.3 W:5.0
- 180° 雙排螃蟹腳 Type

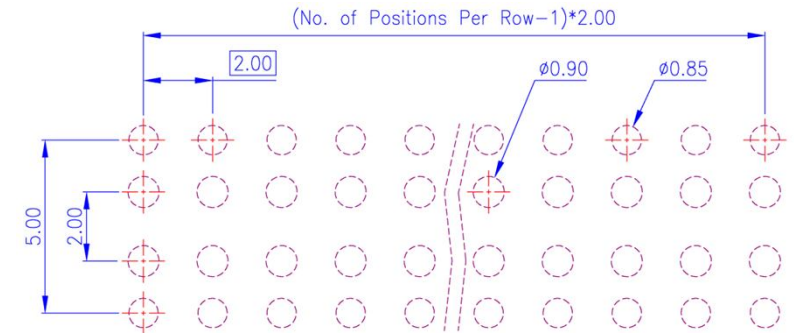
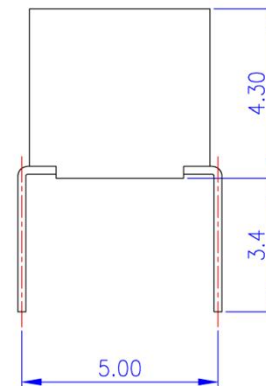
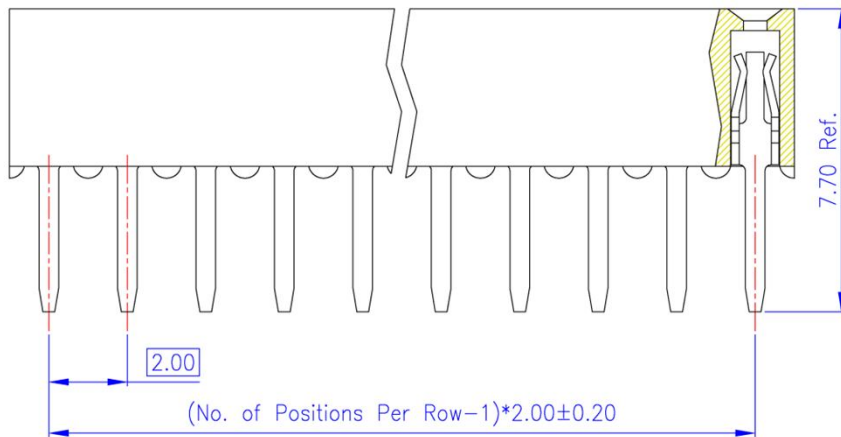

PCB Layout
(Top View)



Material and Finish

1. Housing: Nylon 6T (UL94V-0), Black.
2. Terminal: Copper Alloy (t=0.20mm), Gold Plating.

Electrical Characteristics

1. Current Rating: 3.0 Amp. Max..
2. Dielectric Withstand Voltage:
1000V AC RMS for 60Seconds.
3. Insulation Resistance:
1000M Ohms Min. at 1000V DC.
4. Connect Resistance: 30m Ohms Maximum.

Mechanical Characteristics

1. Operating Temperature: -55°C ~ +105°C



鈺滿榮企業股份有限公司 ACMELUX CO., LTD.

TEL:886-2-85124595

FAX:886-2-85124322

| | | | |
|-----------|------------|--|----------------|
| 0.00±0.30 | SCALE: 1:1 | TITLE: Pitch 2.0mm 180° Dual Rows Pass-Through Entry Vertical Type Female Header Conn. | PART NO: |
| 0.00±0.20 | UNIT: mm | | APP BY: Hung |
| 0.000±0.1 | | | CHK BY: Cheryl |
| | | MATL: RoHS | DR BY: Amos |
| | | DWG. NO. C1884800XXX | A015 |