

CUSTOMER COPY

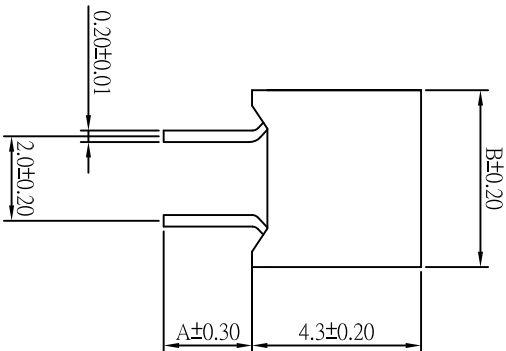

ORDER INFORMATION

188 36 XX XX X

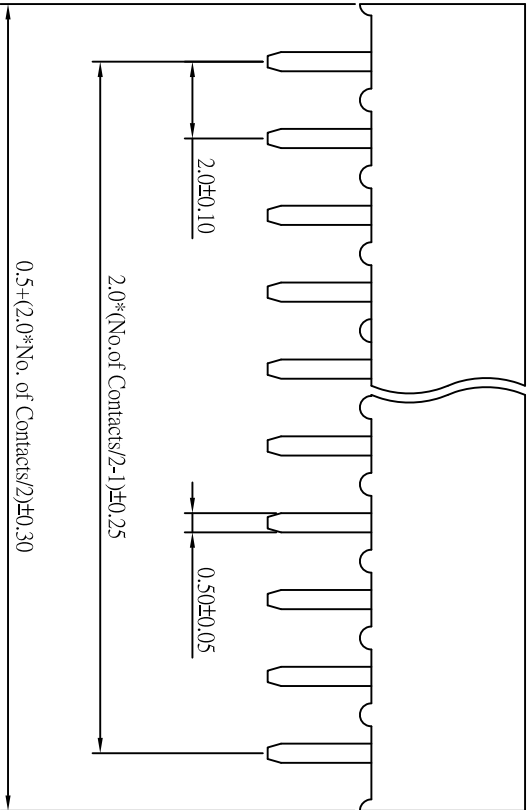
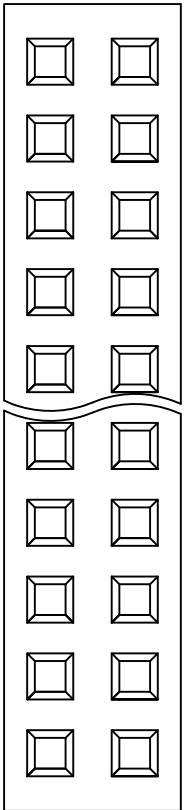
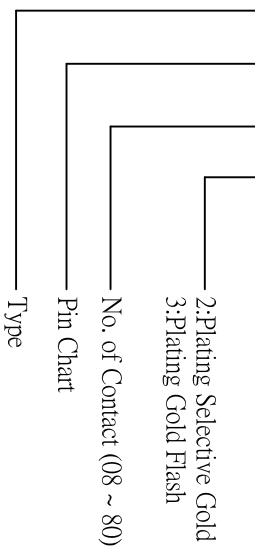

SPECIFICATION

- * Current Rating: 1 A
- * Withstanding Voltage: 500 VAC (1 min.)
- * Insulation Resistance: 1000 Megohms MIN.
- * Contact Resistance: 30 Milliohms MAX.
- * Operating Temperature: -55°C to +105°C
- * Retention Force: 450g MIN.
- * Contact: Phosphor Bronze
- * Insulator: High temperature plastic
- * Plating: All Gold

MATERIAL

Pin Chart (RoHS)

No.	A	B
30	2.45	4.00
31	2.45	4.00
32	2.45	5.20
33	2.40	4.60

TUBE

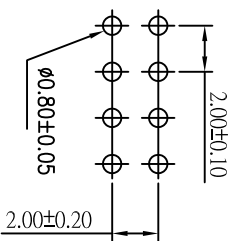

Recommended P.C. Board Hole Layout



REV.	DESCRIPTION	APP.	DATE
A	NEW DESIGN	Amos	2010-04-28

<p>钰满棠企业股份有限公司 ACMELUX CO., LTD.</p> <p>TEL:886-2-85124595 FAX:886-2-85124322</p>		<p>TITLE: Pitch 2.00*2.00mm Dual Rows Type Female Header Connector</p> <p>PART NO: 116300</p>	
0.0±0.30	SCALE: 1:1	DRG. NO. C18836XXXXXX	CHK BY: Cheryl
0.00±0.20	UNIT: mm		DR BY: Amos
0.000±0.1			