

CUSTOMER COPY

REV.	DESCRIPTION	APP.	DATE
A	NEW DESIGN	Amos	2011-03-03

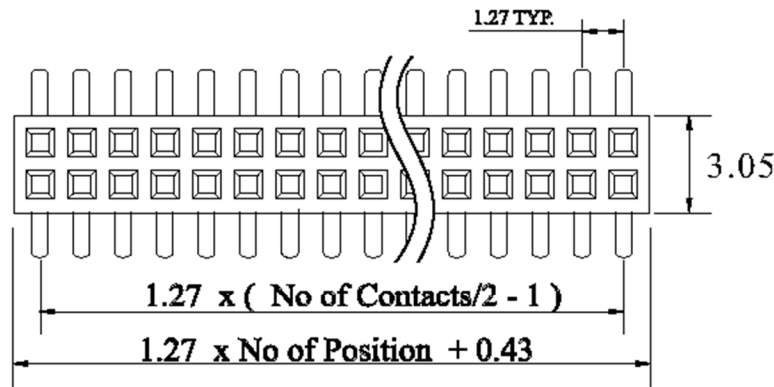

ORDER INFORMATION

186 54 32 XX X

2:Plating Selective Gold
3:Plating Gold Flash

No. of Contact (04 ~ 100)
00:100 Pin

H=3.45 W=4.5

Type

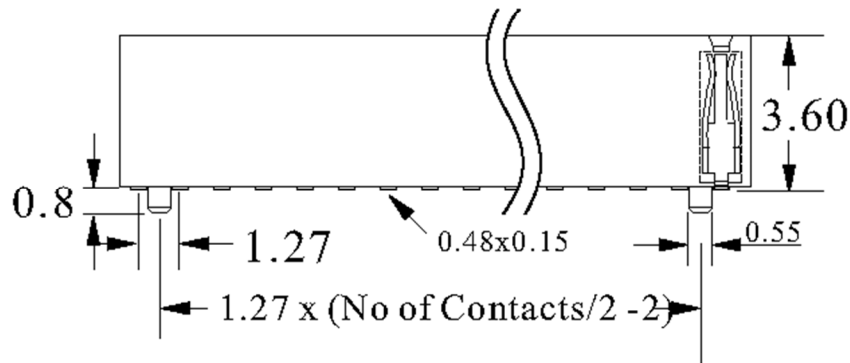

Recommended P.C.Board Hole Layout :

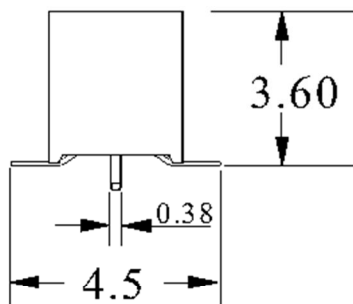
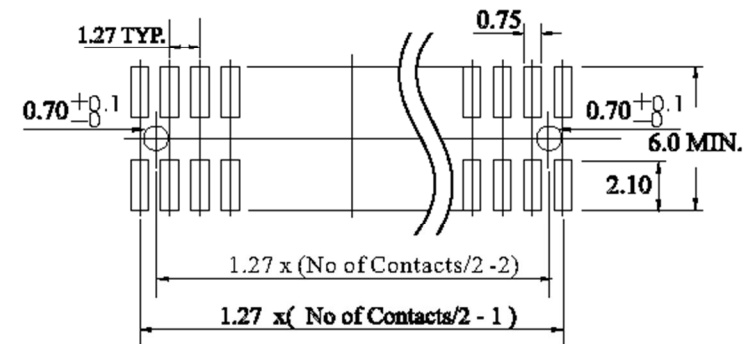

SPECIFICATIONS

Current rating : 1 Amps
Dielectric Withstanding : AC 500V
Contact resistance : 20 Milliohms Max.
Insulation resistance : 5000 Megohms Min.
Temperature range : - 40°C ~ + 105°C

MATERIAL :

Housing : High Temperature Thermoplastic
Terminal : Phosphor Bronze



鈺滿榮企業股份有限公司 ACMELUX CO., LTD.

TEL: 886-2-85124595

FAX: 886-2-85124322

0.0±0.30	SCALE: 1:1	TITLE:	PART NO:
0.00±0.20	UNIT: mm	Pitch 1.27mm*1.27mm	APP BY: Hung
0.000±0.15		SMD Dual Row Female Header	CHK BY: Cheryl
		MATL: RoHS (LCP)	DR BY: Amos
		DWG. NO. C1865432XXX	A225