

CUSTOMER COPY

REV.	DESCRIPTION	APP.	DATE
A	NEW DESIGN	Amos	2012-12-06

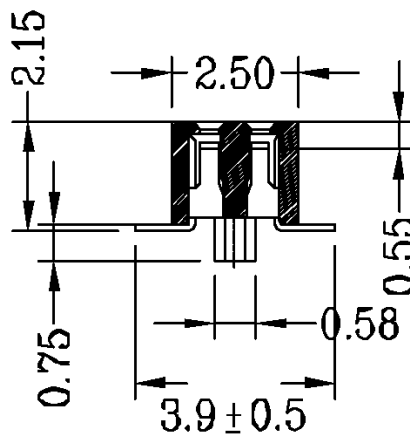
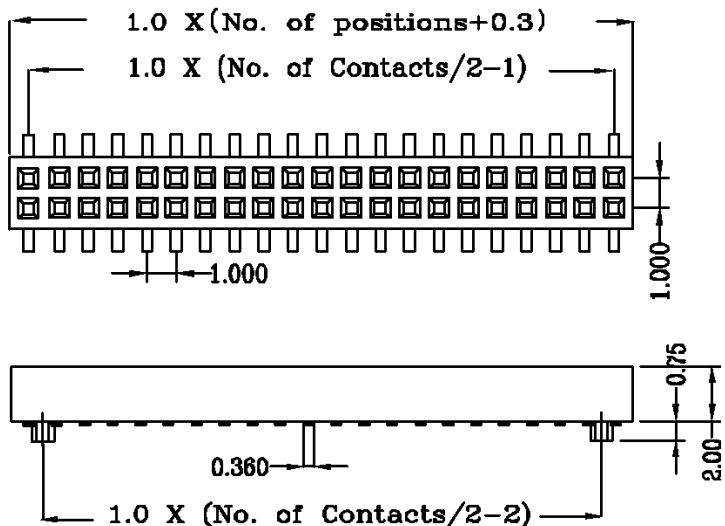

ORDER INFORMATION

185 54 53 XX X

1:Plating Tin
3:Plating Gold Flash

No. of Contact

H:2.0mm W:3.9mm LCP

SMT Type

SPECIFICATIONS

- * Current Rating : 1 Amps
- * Insulator resistance: 5000 Megohms min.
- * Dielectric withstanding: AC 500 V
- * Operating Temperature: -40°-+105°C
- * Max Processing Temp: 230° for 30~60 seconds
(260° for 10 seconds)
- * Contact Material: Phosphor bronze
- * Housing: L.C.P (UL 94 V-0)

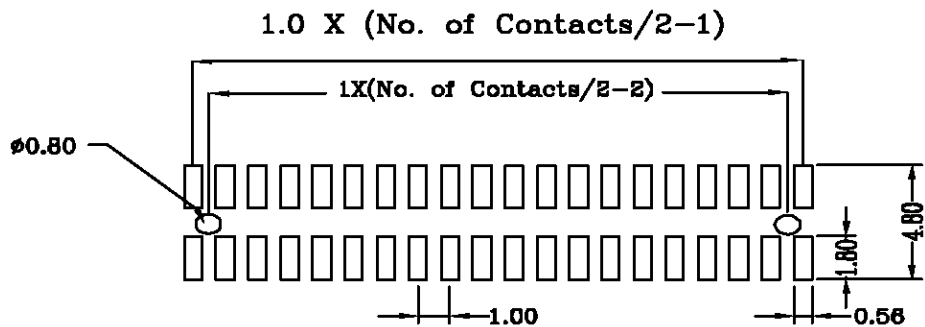

Recommended P.C.B. Layout



鈺滿榮企業股份有限公司 ACMELUX CO., LTD.

TEL:886-2-85124595

FAX:886-2-85124322

0.0±0.38	SCALE: 1:1	TITLE:	PART NO:
0.00±0.25	UNIT: mm	Pitch 1.0mm SMT雙排有定位柱	APP BY: <i>Hung</i>
0.000±0.13		H=2.0mm Type Female Header	CHK BY: <i>Cheryl</i>
		MATL: RoHS	DR BY: <i>Amos</i>
		DWG. NO. C1855453XXX	A223