

CUSTOMER COPY

REV.	DESCRIPTION	APP.	DATE
A	NEW DESIGN	Amos	2012-10-15

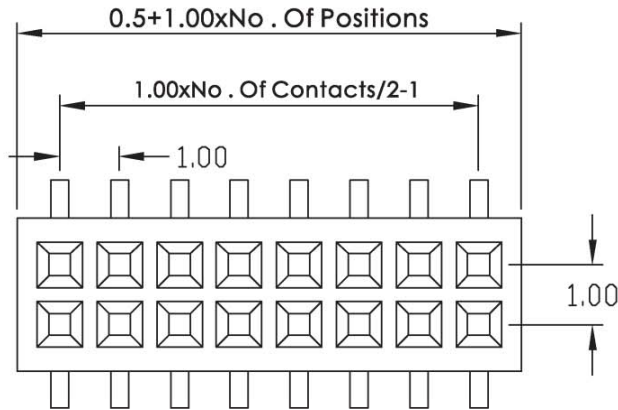

Recommended PCB Layout

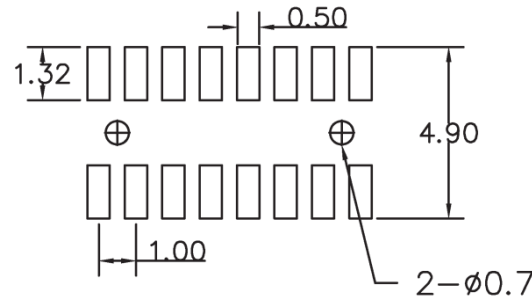

ORDER INFORMATION

185 54 51 XX X

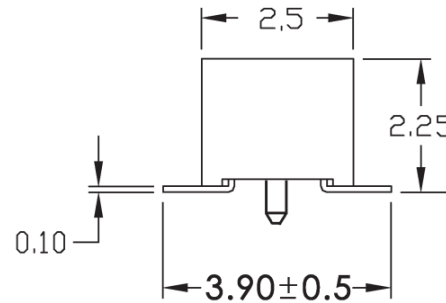
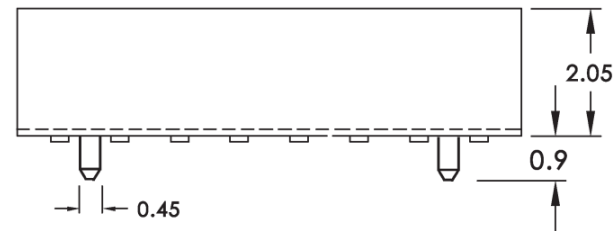
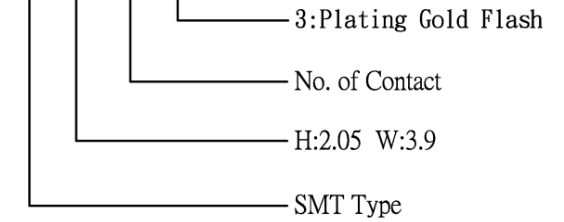

SPECIFICATIONS

Current rating : 1 Amp
 Dielectric Withstanding : AC 200V
 Contact resistance : 20 Milliohms Max.
 Insulation resistance : 500 Megohms Min.
 Temperature range : - 40 °C ~ + 105 °C
 Contact : Copper Alloys
 Housing : Thermoplastic UL94V-0



鈺滿榮企業股份有限公司 ACMELUX CO., LTD.

TEL:886-2-85124595

FAX:886-2-85124322

0.0±0.38	SCALE: 1:1	TITLE:	PART NO:
0.00±0.25	UNIT: mm	Pitch 1.0mm Dual Rows SMT Type Female Header Connector	APP BY: <i>Hung</i>
0.000±0.13			CHK BY: <i>Cheryl</i>
		MATL: RoHS	DR BY: <i>Amos</i>
		DWG. NO. C1855451XXX	A225