

CUSTOMER COPY

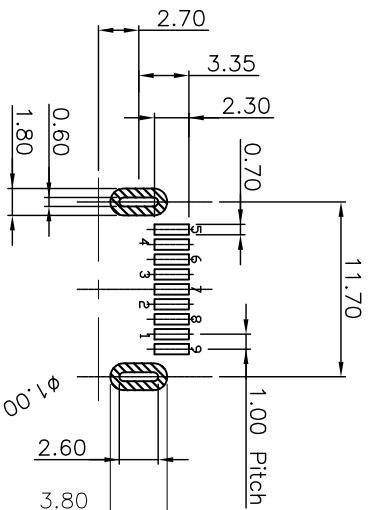

RECOMMENDED P.C.B LAYOUT

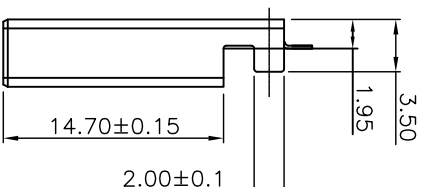
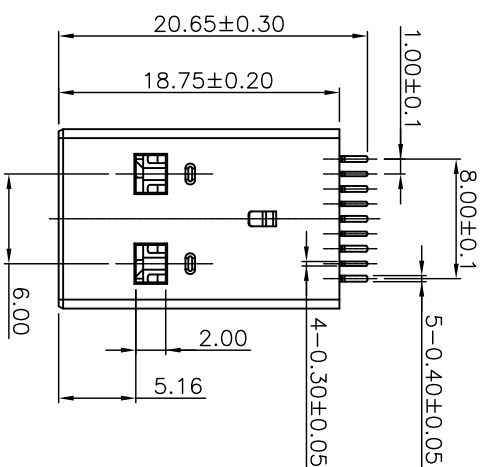
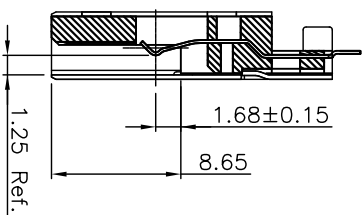
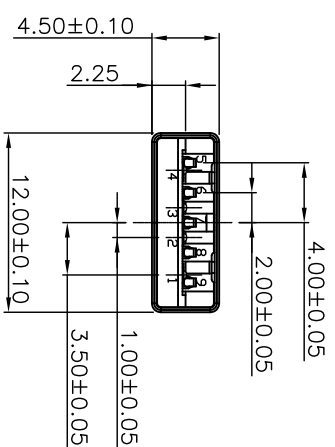

ORDER INFORMATION

1802 50 93 9 X

- 2:Plating Selective Gold
- No. of Contact
- 93:3.0(藍) 無柱 有窗
- 50:沈板 SMT Type

Material:

- A. Insulator : Thermoplastic G.F. UL94V-0.
- B. Contacts : Copper Alloy.
- C. Shell : Metal.
- D. Environmental :
-55 ° C to +105 ° C



鈺滿榮企業股份有限公司 ACMELUX CO., LTD.

TEL:886-2-85124595 FAX:886-2-85124322

0.0±0.30	SCALE: 1:1	TITLE:	PART NO:
0.00±0.20	UNIT: mm	藍色沈板無柱(有窗)	APP BY: <i>Stung</i>
0.000±0.1		SMT Male A Type USB 3.0	CHK BY: <i>Cherryll</i>



MATL: RoHS	DR BY: <i>Amos</i>
DWG. NO. C180250939X	A292