

CUSTOMER COPY

REV.	DESCRIPTION	APP.	DATE
A	NEW DESIGN	Ader	20140829

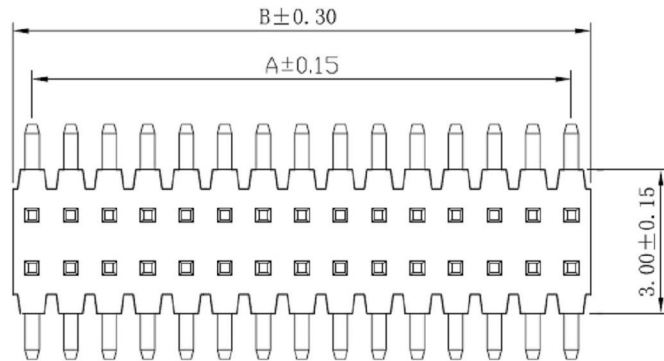
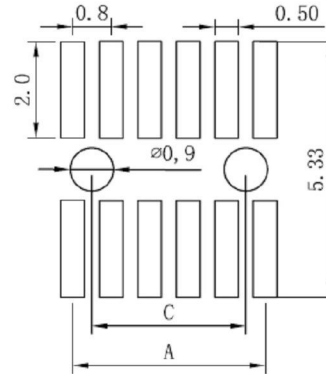
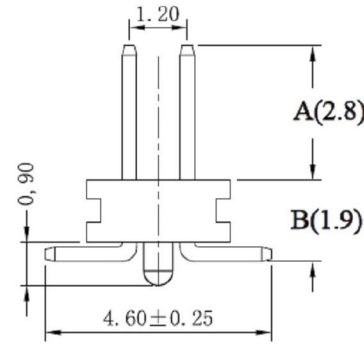
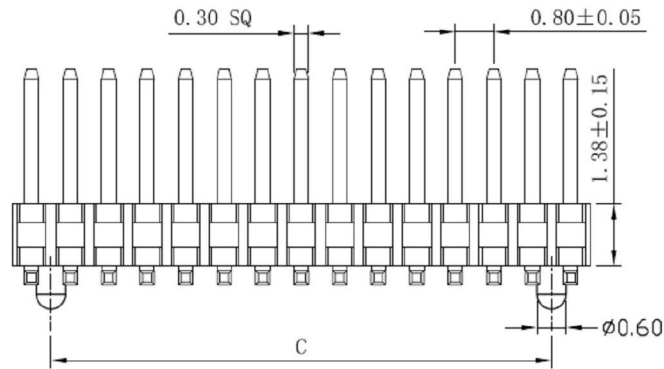

**RECOMMEND P. C. BOARD LAYOUT**  
PCB TOLERANCE: ±0.05 (TOP VIEW)

**\*Order Information**

175 40 00 XX X

- 3: Gold Flash
- No. Of Contact
- H: 1.38 2.8/1.9/4.6
- 雙排 SMT 有柱

	DIMENSIONS	
	A	B
2	0.80	1.60
3	1.60	2.40
4	2.40	3.20
5	3.20	4.00
6	4.00	4.80
7	4.80	5.60
8	5.60	6.40
9	6.40	7.20
10	7.20	8.00
11	8.00	8.80
12	8.80	9.60
13	9.60	10.40
14	10.40	11.20
15	11.20	12.00
16	12.00	12.80
17	12.80	13.60
18	13.60	14.40
19	14.40	15.20
20	15.20	16.00
21	16.00	16.80
22	16.80	17.60
23	17.60	18.40
24	18.40	19.20
25	19.20	20.00
26	20.00	20.80
27	20.80	21.60
28	21.60	22.40
29	22.40	23.20
30	23.20	24.00
31	24.00	24.80
32	24.80	25.60
33	25.60	26.40
34	26.40	27.20
35	27.20	28.00
36	28.00	28.80
37	28.80	29.60
38	29.60	30.40
39	30.40	31.20
40	31.20	32.00
41	32.00	32.80
42	32.80	33.60
43	33.60	34.40
44	34.40	35.20
45	35.20	36.00
46	36.00	36.80
47	36.80	37.60
48	37.60	38.40
49	38.40	39.20
50	39.20	40.00

**SPECIFICATIONS**

- Current Rating: 0.75 Amps
- Withstanding Voltage: AC 5000V
- Insulation Resistance: 1000MΩ Min
- Contact Resistance: 20mΩ Max
- Operation Temperature: -40° to +105°
- Insulator Material: Polyester (UL94V-0)
- Standard: PA6T
- Contact Material: Brass
- Contact Plating: Au or Sn over 50u" Ni
- Max. Processing Temp: 230° C for 30-60 seconds  
(260° C for 10 seconds)



鈺滿榮企業股份有限公司 CMELUX CO., LTD.

TEL: 886-2-85124595

FAX: 886-2-85124322

0.0±0.30	SCALE: UNIT: mm	TITLE: 0.8mm Pin Header Dual Row SMT TYPE	PART NO:
0.00±0.20			APP BY: Hung
0.000±0.1			CHK BY: Cheryl
		MATL: <b>ROHS</b>	DR BY: Ader A225
		DWG. NO. <b>1754000XXX</b>	