

CUSTOMER COPY

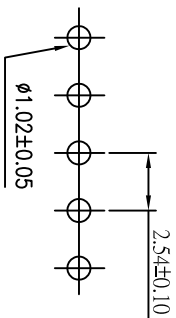

Recommended P.C. Board Hole Layout

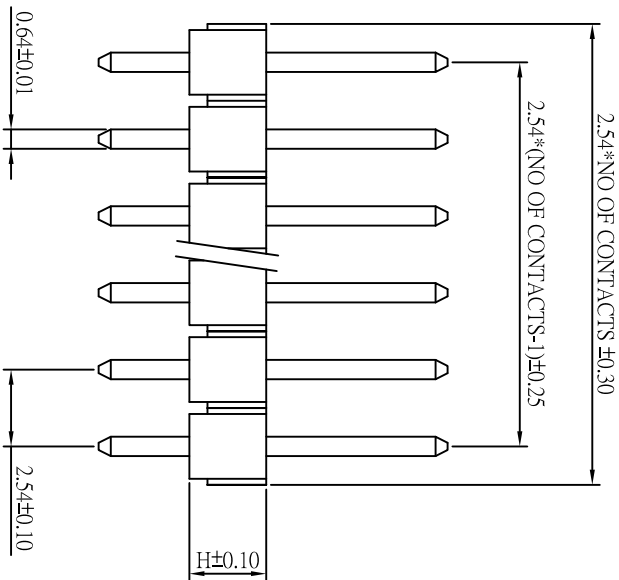
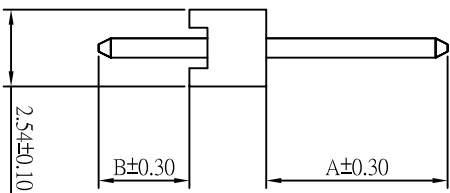

REV.	DESCRIPTION	APP.	DATE
A	NEW DESIGN		

ORDER INFORMATION

174 08 XX XX X

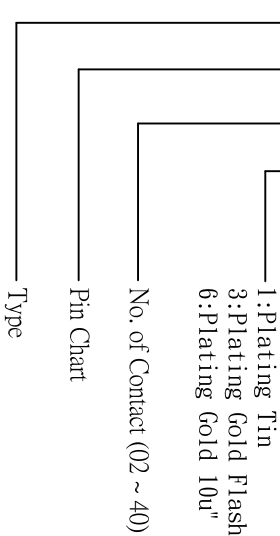

SPECIFICATION

- * Current Rating: 3 A
- * Withstanding Voltage: 800 VAC (1 min.)
- * Insulation Resistance: 1000 Megohms min.
- * Contact Resistance: 30 Milliohms max.
- * Operating Temperature: -40°C to +85°C
- * RETENTION FORCE 750g MIN.

MATERIAL

- * Contact: Brass , 0.64mm square post
- * Insulator: High temperature plastic
- * Plating: Gold



Pin Chart

NO.	A	B	H
00	6.00	3.00	2.54
01	12.50	3.00	2.54
02	3.00	3.00	2.54
03	9.00	3.00	2.54
04	3.10	4.00	2.54
05	7.73	7.73	2.54
06	10.30	3.00	2.54
07	2.50	2.50	2.54
08	6.00	4.00	2.54
09	4.75	3.75	2.54
10	5.50	2.00	2.54
11	12.00	3.00	2.54
12	6.73	6.73	2.54
13	7.75	7.75	2.54

*24 (PURPLE)

NO.	A	B	H
14	12.00	4.00	2.54
15	13.00	2.80	2.54
16	4.20	4.20	2.54
17	4.00	2.00	2.54
18	8.73	8.73	2.54
19	8.00	3.00	2.54
20	2.70	2.40	2.54
21	3.00	5.40	2.54
22	3.10	6.50	2.54
23	5.00	4.00	2.54
24	6.00	3.00	2.54
25	7.10	1.30	2.54
26	15.00	3.00	2.54
27	4.20	3.00	2.54

NO.	A	B	H
28	4.00	3.00	2.54
29	7.00	3.00	2.54
30	10.00	3.00	2.54
31	4.75	2.40	2.54
32	11.00	3.00	2.54
33	23.50	3.00	2.54
34	7.00	3.00	2.54
35	14.46	3.00	2.54
36	3.20	3.00	2.54
37	5.10	3.00	2.54
38	21.5	3.00	2.54
39	9.50	2.00	2.54
40	7.50	2.80	2.54
41	2.66	3.42	1.50

White

NO.	A	B	H
42	5.50	2.50	2.54
43	7.50	3.50	2.54
44	8.50	3.00	2.54
45	11.6	2.90	2.54
46	20.0	2.50	2.54
47	6.00	3.00	2.54
48	3.00	6.00	2.54
49	13.21	2.66	2.54

White

NO.	A	B	H
96	3.00	3.00	1.50
97	22.46	0.00	2.54
98	3.50	3.50	7.62
99	6.00	3.00	1.50



钰满荣企业股份有限公司 ACMELUX CO., LTD.

TEL:886-2-85124595

FAX:886-2-85124322

0.0±0.30	SCALE: 1:1	TITLE:
0.00±0.20	UNIT: mm	Pitch 2.54mm (.100") Single Row
0.000±0.1		Center Pin Header Connector

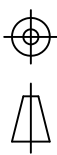

MATL: RoHS (Nylon 6T)

DWG. NO. C17408XXXXXX

PART NO:

APP BY: Hung

CHK BY: Cheryl

DR BY: Amos