

CUSTOMER COPY

REV.	DESCRIPTION	APP.	DATE
A	NEW DESIGN	Amos	2013-08-09

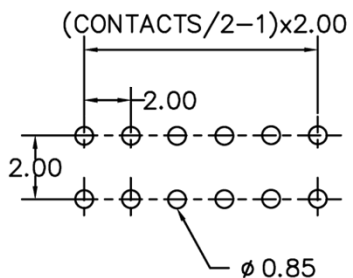
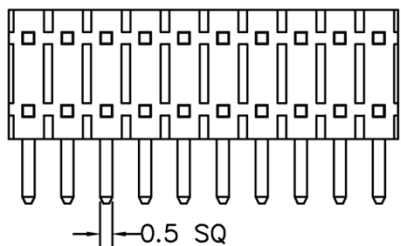

RECOMMENDED P.C.B LAYOUT

ORDER INFORMATION

173 18 01 XX X

- 3: Plating Gold Flash
- No. of Contact
- A=3mm B=3mm
- 90°雙排側插 Type

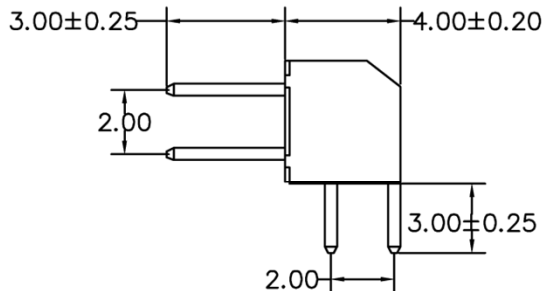
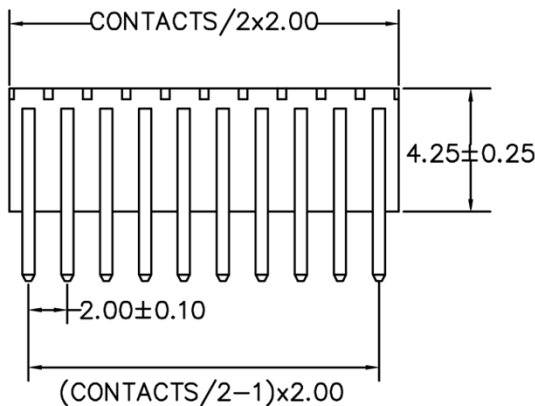

CONTACTS	
2X3	2X13
2X3	2X14
2X4	2X15
2X5	2X16
2X6	2X17
2X7	2X18
2X8	2X20
2X9	2X21
2X10	2X22
2X11	2X23
2X12	2X24
2X13	2X25

MATERIAL  
HOUSING : THERMOPLASTIC UL94V-0  
CONTACT : COPPER ALLOYS

SPECIFICATION  
CURRENT: 1A  
OPERATING TEMPERATURE:  $-55^{\circ}\text{C}$  TO  $+105^{\circ}\text{C}$   
CONTACT RESISTANCE : 20 MILLIOHMS MAX  
INSULATION RESISTANCE : 5000 MEGAOHMS MIN  
DIELECTRIC STRENGTH : 1000 VAC MIN

備註:(公差請以下述爲主)

2\*03~2\*06PIN /首尾PIN公差  $\pm 0.25$  /塑膠總長公差  $\pm 0.35$   
2\*07~2\*13PIN /首尾PIN公差  $\pm 0.30$  /塑膠總長公差  $\pm 0.40$   
2\*16~2\*20PIN /首尾PIN公差  $\pm 0.45$  /塑膠總長公差  $\pm 0.60$



鈺滿榮企業股份有限公司 ACMELUX CO., LTD.

TEL:886-2-85124595

FAX:886-2-85124322

0.0±0.38	SCALE: 1:1	TITLE:	PART NO:
0.00±0.25	UNIT: mm	Pitch 2.0mm 90°雙排側插 Type	APP BY: <i>Hung</i>
0.000±0.15		Pin Header Connector	CHK BY: <i>Cheryl</i>
		MATL: RoHS	DR BY: <i>Amos</i>
		DWG. NO. C1731801XXX	A284