

CUSTOMER COPY

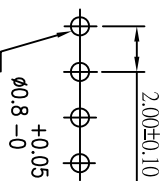

Recommended P.C. Board Hole Layout

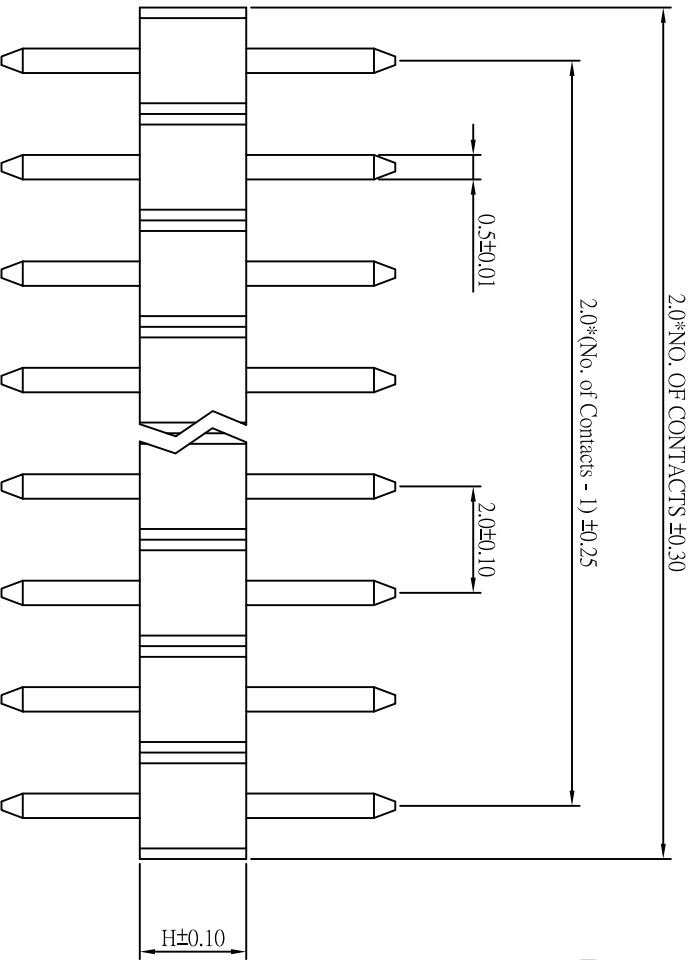
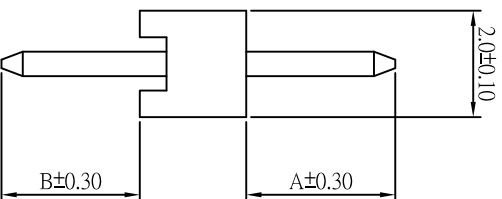

No.	A	B	H	No.	A	B	H	No.	A	B	H	No.	A	B	H
00	4.00	2.80	2.00	09	9.00	2.00	2.00	18	5.00	1.80	2.00	27	8.00	5.00	2.00
01	3.70	3.20	2.00	10	13.60	3.00	2.00	19	2.40	5.00	2.00	28	4.30	2.20	1.50
02	3.80	2.50	2.00	11	11.00	2.00	2.00	20	3.00	3.80	2.00	29	3.70	2.80	1.50
03	4.60	3.40	2.00	12	4.00	2.80	1.50	21	11.00	3.00	2.00	30	7.00	3.00	2.00
04	7.50	2.00	2.00	13	5.00	2.40	2.00	22	3.00	3.00	2.00	31	3.00	2.00	2.00
05	6.50	2.00	2.00	14	2.50	2.50	2.00	23	4.90	2.80	2.00	32	4.00	2.00	1.50
06	3.50	2.20	2.00	15	3.80	3.00	2.00	24	8.00	3.00	2.00	33	6.00	2.40	2.00
07	6.20	2.90	2.00	16	2.40	4.30	2.00	25	4.00	2.30	1.50	34	4.30	2.00	1.50
08	6.00	3.00	2.00	17	4.80	2.00	2.00	26	3.50	2.30	1.50	35	4.30	2.40	2.00

Pin Chart

ORDER INFORMATION

173 08 XX XX X

1:Plating Tin
3:Plating Gold Flash
7:Plating Gold 5u"

No. of Contact (01 ~ 40)

Pin chart

RoHS Type

SPECIFICATION

MATERIAL

- * Current Rating: 1 A
- * Withstanding Voltage: 600 VAC (1 min.)
- * Insulation Resistance: 1000 Megohms MIN.
- * Contact Resistance: 30 Milliohms MAX.
- * Operating Temperature: -40°C to +85°C
- * Retention Force: 600g MIN.
- * Insulator: High Temperature plastic
- * Contact: BRASS
- * Plating: All Gold



钰满荣企业股份有限公司 ACMELUX CO., LTD.

TEL.:886-2-85124595

FAx:886-2-85124322

0.0±0.30	SCALE: 1:1	TITLE:	PART NO:
0.00±0.20	UNIT: mm	Pitch 2.00mm Single Row	109100
0.000±0.1		Center Pin Header Connector	APP BY: Hung

	MATL: RoHS (Nylon)	CHK BY: Cheryl
	DWG. NO. C17308XXXXXX	DR BY: Amos

REV.	DESCRIPTION	APP.	DATE
A	NEW DESIGN		