

CUSTOMER COPY

REV.	DESCRIPTION	APP.	DATE
A	NEW DESIGN	Amos	2012-12-05

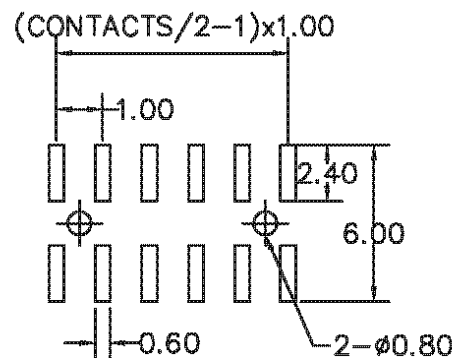
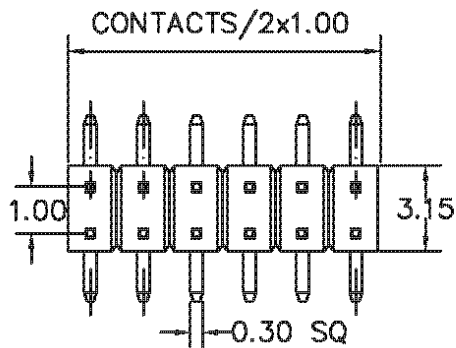

ORDER INFORMATION

170 40 02 XX X

1:Plating Tin
3:Plating Gold Flash

No. of Contact

02: H:1.0mm 1.9/1.4/4.5

雙排SMT有柱 Type

RECOMMENDED P.C.B LAYOUT

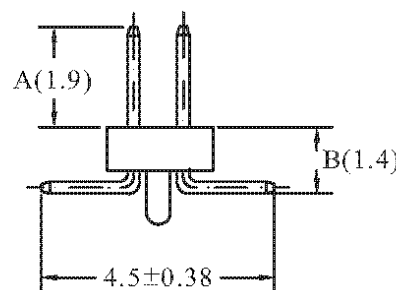
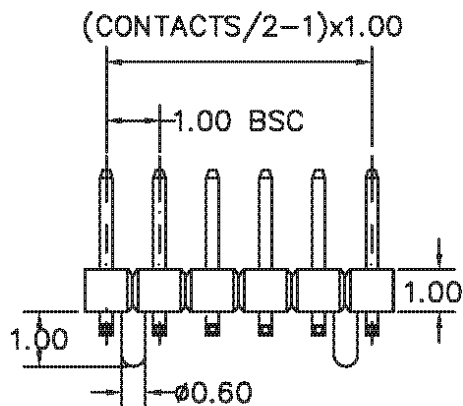

SPECIFICATIONS

Current rating : 1 Amp

Contact Resistance : 20 Milliohms Max .

Insulation resistance : 5000 Megohms Min.

Operating Temperature : - 40°C ~ + 105°C

Withstanding Voltage: AC 500V RMS

Contact Matenal : Copper Alloy

Insulator Materal : Thermoplastic UL 94V-0



鈺滿榮企業股份有限公司 ACMELUX CO., LTD.

TEL:886-2-85124595

FAX:886-2-85124322

0.0±0.38	SCALE: 1:1	TITLE:	PART NO:
0.00±0.25	UNIT: mm	Pitch 1.0mm 雙排SMT有柱 Type	APP BY: <i>Hung</i>
0.000±0.13		Pin Header Connector	CHK BY: <i>Cheryl</i>
		MATL: RoHS	DR BY: <i>Amos</i>
		DWG. NO. C1704002XXX	A225