

CUSTOMER COPY

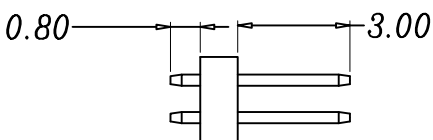

ORDER INFORMATION
1703205 XX X

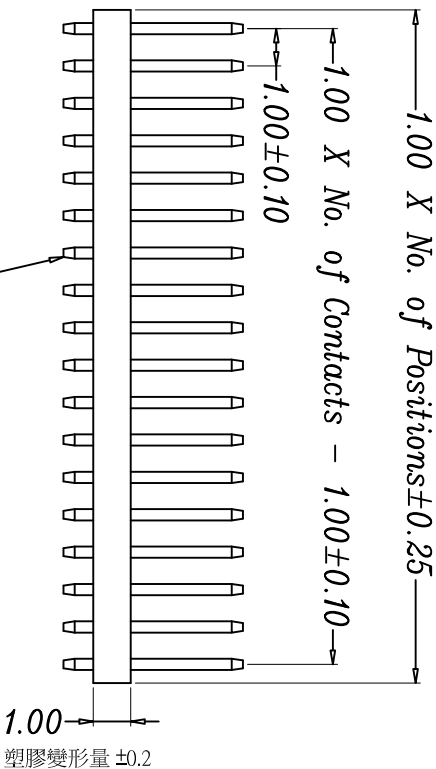
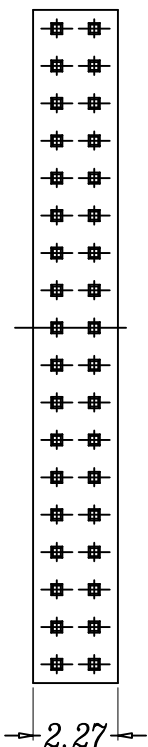
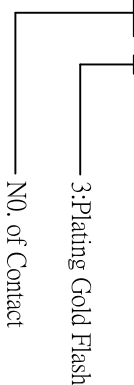

- NOTE:
- 1.MATERIAL:
HOUSING: PA6T 30% G/F UL 94V-0 ;BLACK
CONTACT: BRASS
 - 2.ELECTRICAL:
CURRENT RATING: 1.5 A
CONTACT RESISTANCE:20 Milliohms MAX.
INSULATION RESISTANCE: 500 Megohms MIN.
WITHSTANDING VOLTAGE: 600 VAC
 - 3.FINISH:
CONTACT: 1u" GOLD MIN. PLATING ON CONTACT AREA
 - 4.ENVIRONMENTAL:
OPERATURE RANGE:-40°C TO +105°C

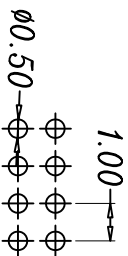

RECOMMENDED P.C.B LAYOUT
 $T = \pm 0.05$

REV.	DESCRIPTION	APP.	DATE
A	NEW DESIGN	Amos	2009-08-06

<p>鈺滿榮企業股份有限公司 ACMELEX CO., LTD. TEL:886-2-85124595 FAX:886-2-85124322</p>		PART NO:
0.0±0.30	SCALE: 1:1	TITLE:
0.00±0.20	UNIT: mm	Pitch 1.0mm 180° 雙排單頭
0.000±0.1	Base=1.0mm Pin Header Connector	APP BY: <i>Stung</i>
	MATL: RoHS	CHK BY: <i>Cherryll</i>
	DWG. NO. C1703205XXX	DR BY: <i>Amos</i>
		C050