

CUSTOMER COPY

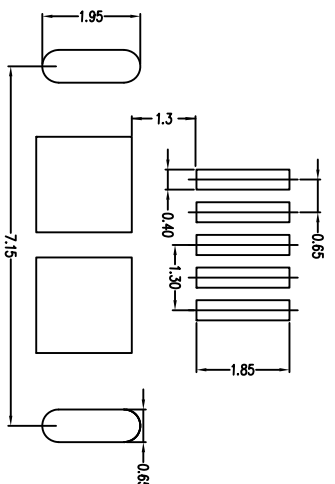
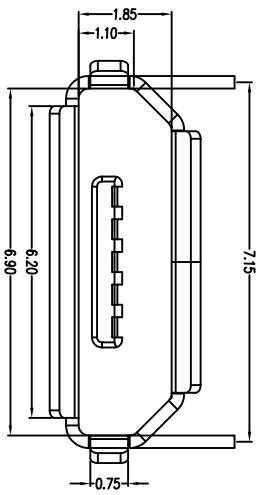

ORDER INFORMATION
1501 11 00 5 X

- 2: Plating Selective Gold
- 5: Plating Selective Gold 15u"
- 6: Plating Selective Gold 30u"
- No. of Contact
- SMT無柱沈板式
- B Type

Material:

- 1.1 Housing: High Temperature thermoplastic with g.f. UL94V-0
- 1.2 Contact: copper alloy, t=0.20mm
- 1.3 Shell: copper alloy, t=0.25mm
- 2. Specification:
 - 2.1 Current rating: 1 A Max.
 - 2.2 Dielectric withstanding voltage: 100 V(ac) for 1 min.
 - 2.3 Contact resistance: 50 mΩ Max.
 - 2.4 Insulation resistance: 100 MΩ Min.
 - 2.5 Total mating force: 3.57 Kgf Max.
 - 2.6 Total unmating force: 1.0 Kgf Min. 0.81-2.05 Kgf Min. after 10000 insertion/extraction cycles
 - 2.7 Temperature range: -30C-80C

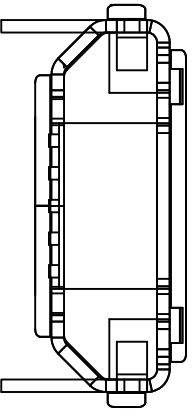
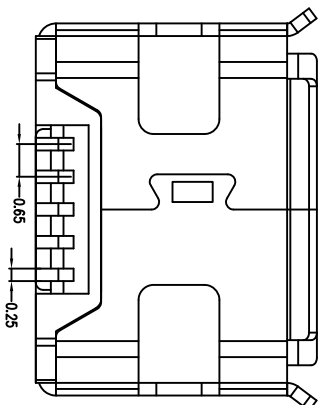
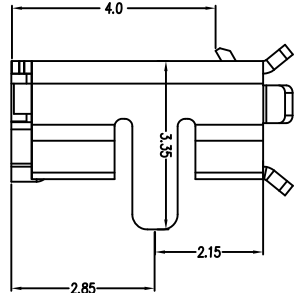
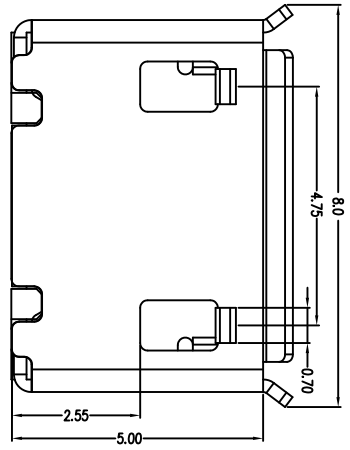

鈺滿榮企業股份有限公司 ACMELUX CO., LTD.

TEL.: 886-2-85124595

FAX: 886-2-85124322

0.0±0.30	SCALE: 1:1	TITLE:	PART NO.:
0.00±0.20	UNIT: mm	SMT Female無柱沈板式B Type	APP BY: <i>Shung</i>
0.000±0.1		Micro USB Connector	CHK BY: <i>Eheryl</i>

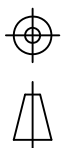

MATL: ROHS	DR BY: <i>Amos</i>
DWG. NO. C150111005X	

A202