

CUSTOMER COPY

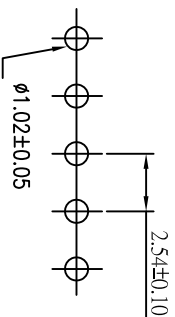

ORDER INFORMATION

114 04 XX XX X

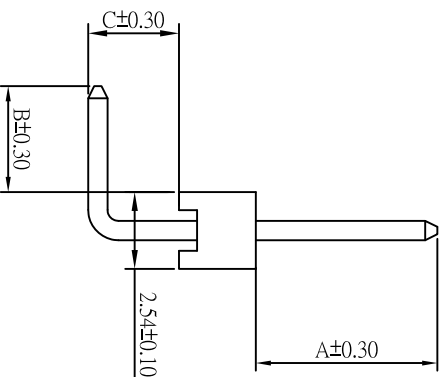
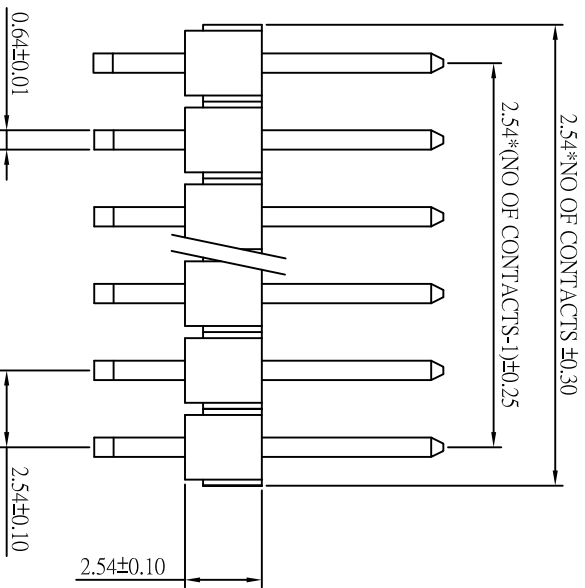
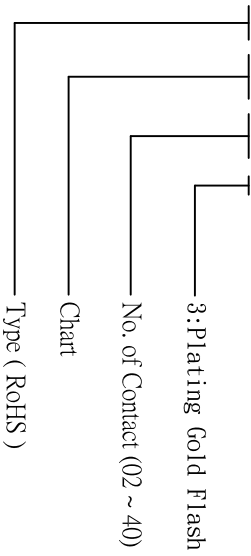

SPECIFICATION

MATERIAL

- \* Current Rating: 3 A
- \* Withstanding Voltage: 800 VAC ( 1 min. )
- \* Insulation Resistance: 1000 Megohms min.
- \* Contact Resistance: 30 Milliohms max.
- \* Operating Temperature: -40°C to +85°C
- \* RETENTION FORCE: 750g MIN.
- \* Plating: Gold
- \* Insulator: High temperature plastic
- \* Contact: Brass C2600~C2700, 0.64mm square post

Pin Chart

| NO. | A    | B    | C    |
|-----|------|------|------|
| 00  | 7.00 | 3.50 | 1.86 |
| 01  | 6.00 | 3.00 | 1.86 |
| 02  | 6.00 | 4.00 | 1.86 |
| 03  | 4.00 | 5.00 | 1.86 |
| 04  | 3.50 | 3.50 | 1.86 |
| 05  | 9.00 | 3.00 | 1.86 |
| 06  | 3.10 | 3.10 | 3.30 |
| 07  | 3.05 | 3.05 | 3.26 |
| 08  | 6.10 | 3.50 | 1.40 |
| 09  | 3.60 | 3.00 | 1.86 |
| 10  | 6.00 | 3.00 | 0.64 |

Pin Chart

| NO. | A    | B    | C    |
|-----|------|------|------|
| 11  | 6.00 | 3.00 | 1.50 |
| 12  | 6.00 | 3.10 | 1.30 |
| 13  | 8.30 | 3.00 | 1.86 |
| 14  | 6.00 | 2.30 | 1.86 |
| 15  | 6.00 | 3.00 | 4.00 |
| 16  | 8.00 | 2.54 | 1.86 |
| 17  | 6.40 | 3.10 | 1.32 |
| 18  | 7.00 | 3.00 | 2.00 |

Recommended P.C. Board Hole Layout



钰满荣企业股份有限公司 ACME LUX CO., LTD.

TEL:886-2-85124595

FAX:886-2-85124322

|           |            |                                 |              |
|-----------|------------|---------------------------------|--------------|
| 0.0±0.30  | SCALE: 1:1 | TITLE:                          | PART NO:     |
| 0.00±0.20 | UNIT: mm   | Pitch 2.54mm (.100") R/A Single | 111200       |
| 0.000±0.1 |            | Row Center Pin Header Connector | APP BY: Hung |



MATL: RoHS (PBT)

CHK BY: Cheryl

DWG. NO. C11404XXXXXX

DR BY: Amos

A021