

CUSTOMER COPY

REV.	DESCRIPTION	APP.	DATE
A	NEW DESIGN	Amos	2010-04-28

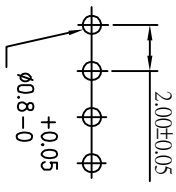

Recommended P.C. Board Hole Layout

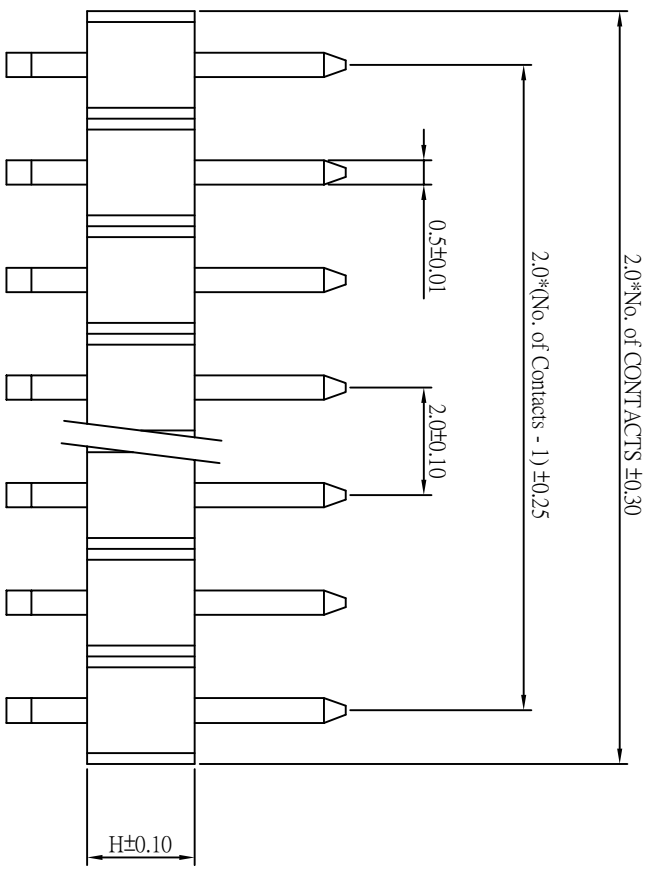
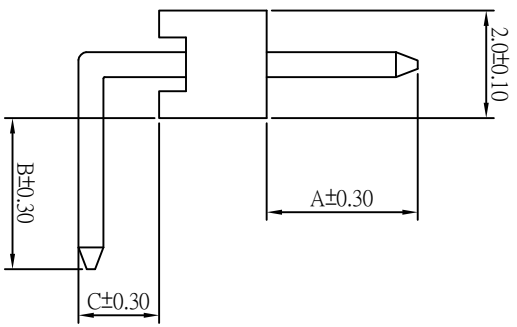

Pin Chart

No.	A	B	C	H
00	4.00	2.80	2.00	2.00
01	3.00	3.00	1.20	2.00
02	2.50	2.50	0.50	2.00
03	3.50	2.50	0.50	2.00
04	3.70	3.00	4.50	2.00
05	4.00	4.98	6.00	2.00
06	3.50	3.50	2.50	2.00
07	4.00	2.80	1.80	2.00

No.	A	B	C	H
08	4.00	2.80	1.25	2.00
09	3.60	3.60	2.25	2.00
10	3.00	2.00	2.00	2.00
11	2.00	5.00	1.00	2.00
12	4.00	2.40	1.00	1.50
13	0.00	6.80	2.00	1.50
14	3.80	3.00	1.55	2.00
15	3.60	3.20	2.75	2.00

No.	A	B	C	H
16	3.00	2.80	1.25	2.00
17	6.00	2.80	2.00	2.00

ORDER INFORMATION
113 04 XX XX X

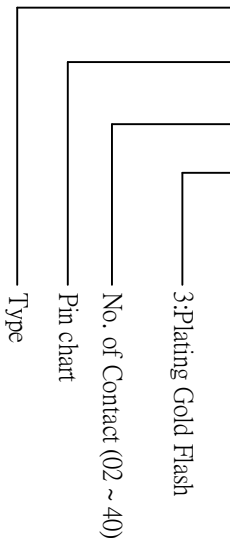

SPECIFICATION

MATERIAL

- * Current Rating: 1 A
- * Withstanding Voltage: 600 VAC (1 min.)
- * Insulation Resistance: 1000 Megohms MIN.
- * Contact Resistance: 30 Milliohms MAX.
- * Operating Temperature: -40°C to +85°C
- * Retention Force: 600g MIN.
- * Contact: BRASS
- * Insulator: High temperature plastic
- * Plating: All Gold



钰满蔡企业股份有限公司 ACMELUX CO., LTD.
TEL:886-2-85124595 FAX:886-2-85124322

0.0±0.30	SCALE: 1:1	TITLE:	PART NO:
0.00±0.20	Pitch: 2.0mm(.079") 90°	Single Row Type Center	109220
0.000±0.1	UNIT: mm	Pin Header Connector	APP BY: Hung
			CHK BY: Cheryl
			DR BY: Amos